



LUOKAI
WE MAKE FLOW BETTER



AT

PNEUMATIC ACTUATOR

Intelligent Process Control

Build A Quality

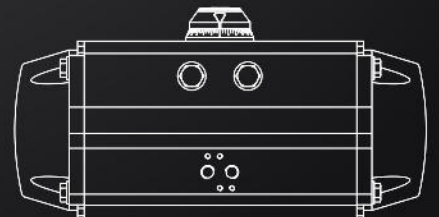

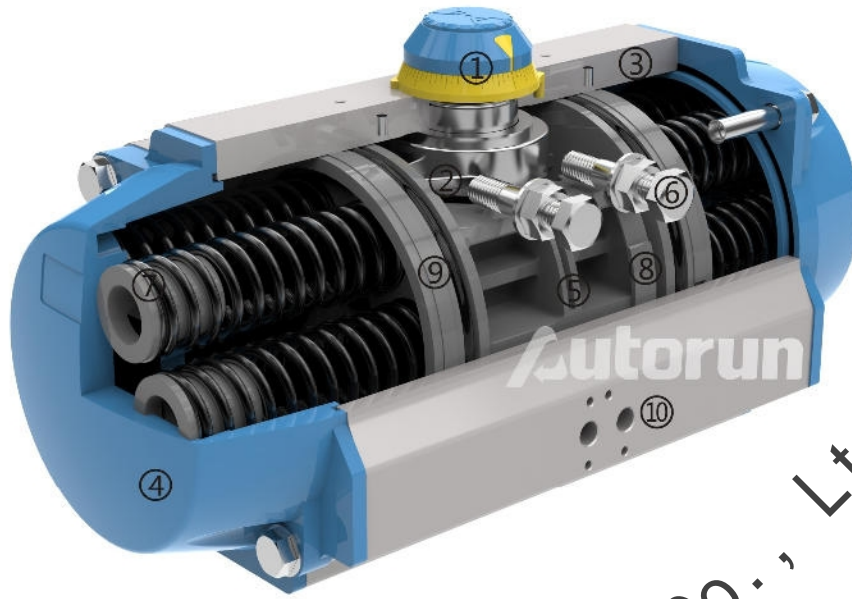

性能特点 Performance Feature

1. 指示器 Indicator

指示器符合VID/VIE3845 NAMUR标准，便于安装限位开关、定位器等附件。

The indicator conforms to the VID/VIE3845 NAMUR standard, which is convenient for installing limit switch, positioner and other accessories.

2. 输出轴 Output Shaft

镀镍合金钢一体式锻压输出轴的设计符合NAMUR、ISO5211、DIN3337标准。特殊标准可根据客户要求去定制。

The design of the one-body forging and pressing output shaft of nickel-plated alloy steel is in accordance with NAMUR, ISO5211 and DIN3337 standard. Special standards can be customized according to the customer.

3. 缸体 Cylinder Block

由优质铝合金挤压成形，表面进行硬质阳极氧化处理、特氟龙涂层。

It is made of high quality aluminum alloy extrusion, the surface is coated with hard anodic oxidation and teflon coating.

4. 端盖 End Cover

铝合金压铸，表面阳极硬化处理、金属聚酯涂层。

Aluminum alloy die casting, surface with anodic hardening treatment and metal polyester coating.

5. 活塞 Piston

采用铸铝硬质氧化处理

Cast aluminum with hard oxidation

6. 调节螺栓 Adjustment Bolt

两个独立行程调节螺栓可以方便精确的在 $\pm 5^\circ$ 以内调整阀门的开合角度。

Two independent adjustment bolts realizes accurate adjustment within $\pm 5^\circ$ of the angle of the valve opening and closing.

7. 弹簧 Spring

采用优质弹簧钢，预压装配。能方便的拆卸或改变弹簧数量满足不同的力矩输出范围。

Use high quality spring steel, prepress assembly. Can easily remove or change the number of springs to meet different torque output ranges

8. 活塞环 Piston Ring

采用低摩擦、长寿命复合材料，维修更换方便。

Use low friction and long life composite material, convenient repair and replace.

9. 密封 Seal

常温下使用丁腈橡胶，高温和低温工况下，根据客户要求使用特殊的密封。

Use nitrile rubber under normal temperature, special seal is available according to the customer's requirement for high temperature and low temperature.

10. 气源接口 Air Connection

符合NAMUR标准，可直接安装NAMUR标准电磁阀。

It complies with NAMUR standard and can be directly mounted with NAMUR standard solenoid valve.

11. 所有紧固件均采用不锈钢材料

All fasteners are made of stainless steel.

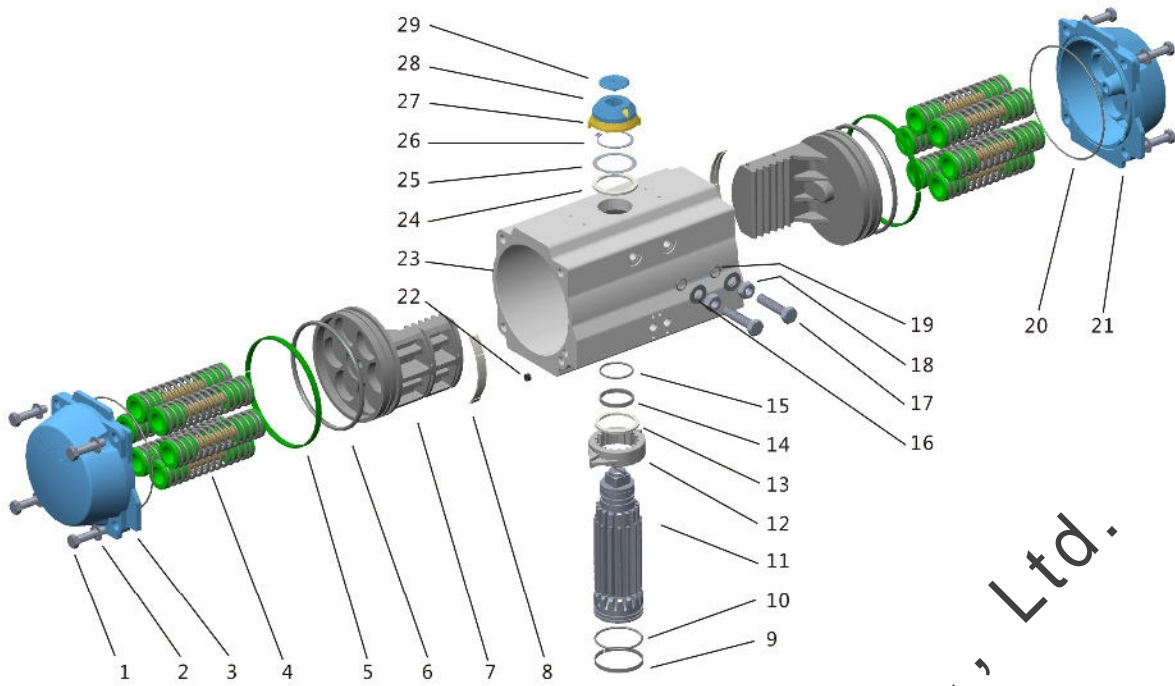

零部件明细表 Components Material

序号 NO	名称 Name	单台数量 Qty for Each Unit	标准材料 Standard Material	可选材料 Materials Selectable
1	螺栓 Bolt	8	不锈钢 Stainless Steel	
2	螺栓垫片 Bolt Washer	8	不锈钢 Stainless Steel	
3	左端盖 Left Cover	1	压铸铝合金 Aluminum Die Casting	不锈钢 Stainless Steel
4	弹簧组件 Spring Components	5-12	合金弹簧钢 Alloy Spring Steel	
5	活塞环 Piston Ring	2	POM	
6	O型圈 (活塞) "O" Ring (piston)	2	丁腈橡胶 NBR	
7	活塞 Piston	2	压铸铝合金 Aluminum Die Casting	
8	导向环 Guide Ring	2	Pa66	
9	轴承 (轴下) Bearing (output shaft bottom)	1	POM	
10	O型圈 (轴下) "O" Ring (output shaft bottom)	1	丁腈橡胶 NBR	氟橡胶硅橡胶 FPM/Q
11	输出轴 Output Shaft	1	碳钢 Carbon Steel	不锈钢 Stainless Steel
12	凸轮 Cam	1	不锈钢 Stainless Steel	
13	垫片 Gasket	1	POM	
14	轴承 (轴上) Bearing (at the top of the shaft)	1	POM	
15	O型圈 (轴上) "O" Ring (at the top of the shaft)	1	丁腈橡胶 NBR	氟橡胶硅橡胶 FPM/Q
16	螺母 Nut	2	不锈钢 Stainless Steel	
17	调节螺栓 Adjustment Bolt	2	不锈钢 Stainless Steel	
18	垫片 Gasket	2	不锈钢 Stainless Steel	氟橡胶硅橡胶 FPM/Q
19	O型圈 (调节螺栓) "O" Ring (adjusting bolt)	2	丁腈橡胶 NBR	氟橡胶硅橡胶 FPM/Q
20	O型圈 (端盖) "O" Ring (cover)	2	丁腈橡胶 NBR	不锈钢 Stainless Steel
21	右端盖 Right Cover	1	压铸铝合金 Aluminum Die Casting	氟橡胶硅橡胶 FPM/Q
22	堵头 Plug	1	丁腈橡胶 NBR	不锈钢 Stainless Steel
23	缸体 Block	1	挤压铝合金 Aluminum Extrusion	
24	垫片 Gasket	1	POM	
25	垫片 Gasket	1	不锈钢 Stainless Steel	
26	轴用挡圈 Shaft Ring	1	不锈钢 Stainless Steel	
27	指示器固定架 Indicator Supporting Structure	1	ABS	
28	指示器主体 Main Body of the Indicator	1	ABS	
29	螺钉 Bolt	1	ABS	

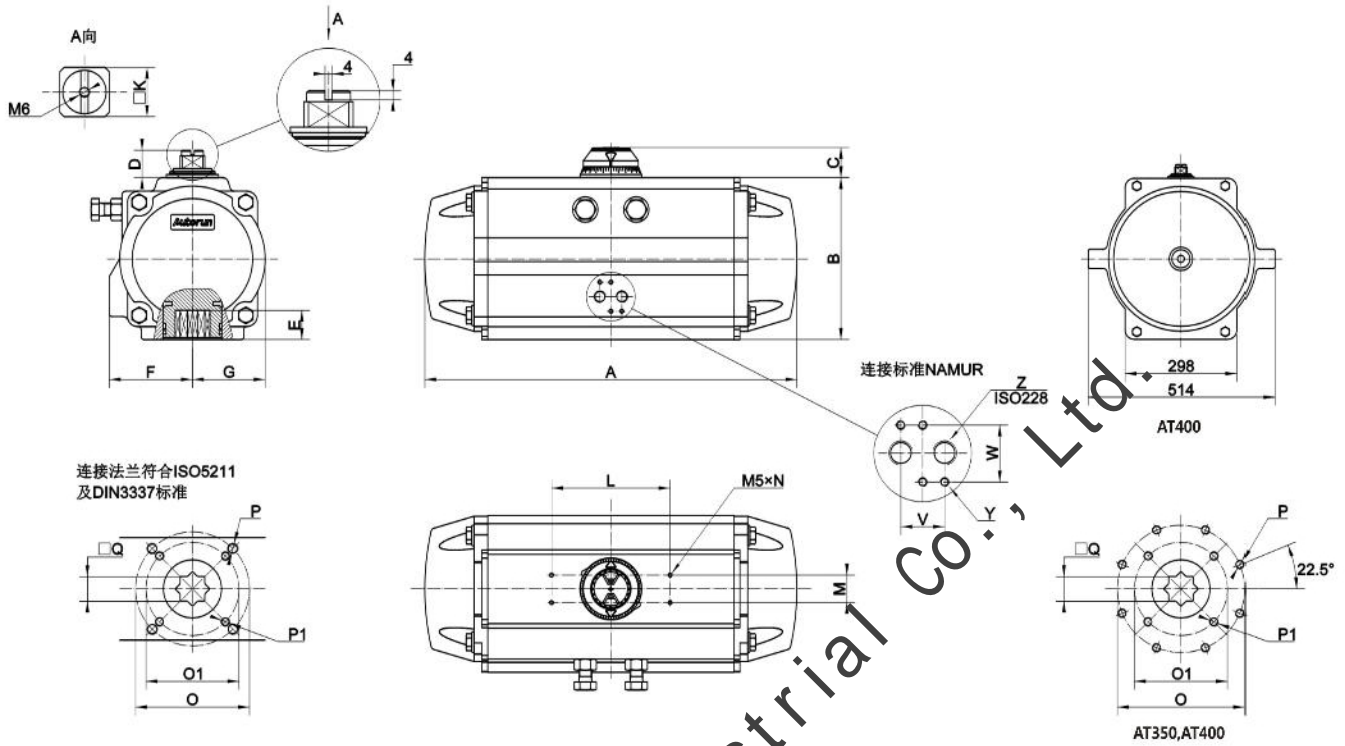

外形及连接尺寸 Dimensions and Connection(mm)

型号Model	AT042	AT050	AT063	AT075	AT088	AT100	AT115	AT125	AT145	AT160	AT190	AT210	AT240	AT270	AT300	AT350	AT400
ISOflange	F03/F05	F03/F05	F03/F05	F05/F07	F05/F07	F07/F10	F07/F10	F07/F10	F10/F12	F10/F12	F12/F14	F12/F14	F16	F16	F16	F16/F25	F16/F25
A	122	143	162	212	248	270	318	345	408	440	530	592	670	723	870	935	1035
B	55	68	84	100	115	126	145	157	178	196	233	255	292	332	355	410	466
C	20	20	20	23	23	23	23	33	33	33	33	33	33	33	33	33	33
D	18	18	19	20	20	20	20	30	30	30	30	30	25	25	25	25	25
E	12	12	16	16	19	19	24	24	29	29	38	38	48	48	48	48	48
F	33	40.5	46	52	56	67	78	80	91	100	112	121	130	147	173	195	260
G	24	29	36	41.5	49	56	64	71	80	88	105	116	130	147	161	190	260
K	10	11	11	17	17	17	17	27	27	27	27	27	36	36	36	36	36
L	50	80	80	80	80	80	80	80	130	130	130	130	130	130	130	130	130
M	30	30	30	30	30	30	30	30	30	30	30	30	30	30	30	30	30
N	4-M5x9	4-M5x9	4-M5x9	4-M5x9	4-M5x9	4-M5x9	4-M5x9	4-M5x9	4-M5x9	4-M5x9	4-M5x9	4-M5x9	4-M5x9	4-M5x9	4-M5x9	4-M5x9	4-M5x9
O	50	50	50	70	70	102	102	102	125	140	140	140	165	165	165	254	254
P	4-M6x9	4-M6x9	4-M6x9	4-M8x12	4-M8x12	4-M10x15	4-M10x15	4-M10x15	4-M12x18	4-M16x24	4-M16x24	4-M16x24	4-M20x30	4-M20x30	4-M20x30	8-M16x24	8-M16x24
O1	36	36	36	50	50	70	70	70	102	102	125	125	—	—	—	165	165
P1	4-M5x8	4-M5x8	4-M5x8	4-M6x9	4-M6x9	4-M8x12	4-M8x12	4-M8x12	4-M10x15	4-M10x15	4-M12x18	4-M12x18	—	—	—	4-M20x30	4-M20x30
Q	9	11	14	14	17	17	22	22	27	27	36	36	46	46	46	46	46
V	20	24	24	24	24	24	24	24	24	24	24	24	24	40	40	40	40
W	29	36	36	36	36	36	36	36	36	36	36	36	36	45	45	45	45
Y	4-M4x9	4-M5x9	4-M5x9	4-M5x9	4-M5x9	4-M5x9	4-M5x9	4-M5x9	4-M5x9	4-M5x9	4-M5x9	4-M5x9	4-M5x9	4-M6x10	4-M6x10	4-M6x10	4-M6x10
Z	G1/8"	G1/8"	G1/8"	G1/8"	G1/8"	G1/4"	G1/4"	G1/4"	G1/4"	G1/4"	G1/4"	G1/4"	G1/4"	G3/8"	G1/2"	G1/2"	G1/2"

输出扭矩 Output Torque

双作用式输出扭矩 Double Acting Output Torque(Nm)

执行器型号 Actuator Model	2.5bar	3.0bar	3.5bar	4.0bar	4.5bar	5.0bar	5.5bar	6.0bar	7.0bar	8.0bar
AT042D	3.6	4.3	5	5.7	6.4	7.3	8	8.7	10	11.6
AT050D	8.3	10.0	11.6	13.3	15.0	16.6	18.3	19.9	23.3	26.6
AT063D	14.7	17.6	20.5	23.5	26.4	29.3	32.2	35.2	41.0	46.9
AT075D	29.1	34.9	40.7	46.5	52.3	58.2	64.0	69.8	81.4	93.0
AT088D	45.7	54.9	64.0	73.2	82.3	91.5	101	110	128	146
AT100D	66.5	79.7	93.0	106	120	133	146	160	186	213
AT115D	107	129	150	172	193	215	236	258	301	344
AT125D	138	166	194	221	249	277	304	332	387	443
AT145D	217	261	304	348	391	434	478	521	608	695
AT160D	283	340	397	453	510	567	623	680	793	907
AT190D	538	646	753	861	969	1077	1185	1292	1508	1723
AT210D	658	789	920	1052	1184	1316	1447	1579	1842	2105
AT240D	966	1160	1352	1546	1740	1933	2126	2320	2706	3093
AT270D	1468	1761	2055	2349	2642	2936	3229	3523	4110	4697
AT300D	1908	2289	2670	3052	3434	3815	4197	4578	5341	6104
AT350D	2856	3427	3998	4570	5141	5712	6283	6854	7997	9139
AT400D	4069	4883	5697	6511	7325	8139	8953	9767	11394	13022

单作用式输出扭矩 (弹簧复位) Single Action Output Torque(Spring Return)(Nm)

执行器型号 Actuator Model	弹簧数量 Spring Quantity	空气压力扭矩 Air Pressure Torque													
		4.5Bar		5.0Bar		5.5Bar		6.0Bar		7.0Bar		8.0Bar		弹簧复位扭矩 Spring Return Torque	
		0° 开始 Start	90° 结束 End	0° 开始 Start	90° 结束 End	0° 开始 Start	90° 结束 End	0° 开始 Start	90° 结束 End	0° 开始 Start	90° 结束 End	0° 开始 Start	90° 结束 End	0° 开始 Start	90° 结束 End
AT050S	10	8.2	5.2	9.8	6.9	11.5	8.5	13.2	10.2	16.5	13.5	19.8	16.8	9.7	6.8
AT063S	10	15.3	9.4	18.2	12.4	21.1	15.3	24.1	18.2	29.9	24.1	35.8	29.9	16.9	11.1
AT075S	10	30.2	17.7	36	23.5	41.8	29.3	47.6	35.1	59.2	46.7	70.9	58.4	34.6	22.1
AT088S	10	45.6	24.5	54.7	33.7	63.9	42.8	73	52	91.3	70.2	110	88.5	57.8	36.7
AT100S	10	68.9	40.7	82.2	54	95.5	67.3	109	80.5	135	107	162	134	78.8	50.6
AT115S	10	111	62.1	133	83.6	154	105	176	127	219	170	261	212	131	82
AT125S	10	144	84	172	112	200	140	227	167	283	223	338	327	165	105
AT145S	10	227	133	270	177	313	220	357	263	444	350	531	437	258	165
AT160S	10	286	178	343	235	399	291	456	348	569	461	683	575	332	224
AT190S	10	440	210	656	426	765	535	871	641	1087	857	1302	1072	586	379
AT210S	10	473	253	737	517	605	657	1000	780	1263	1043	1526	1306	719	521
AT240S	10	887	566	1066	745	1246	923	1423	1102	1781	1459	2138	1817	1042	721
AT270S	10	1472	982	1758	1281	2059	1567	2345	1868	2932	2455	3519	3042	1490	1060
AT300S	10	1814	1074	2193	1458	2577	1837	2956	2221	3719	2984	4482	3747	2122	1460
AT350S	10	2531	1361	3105	1929	3673	2503	4247	3071	5390	4212	6532	5356	3405	2346
AT400S	10	3833	3041	4640	2653	5461	4669	6268	4281	7895	5908	9523	7526	4115	2624