

## 2W Series 2/2-Way Direct Acting Solenoid Valve · Normally Closed

### Construction Dimensions Chart

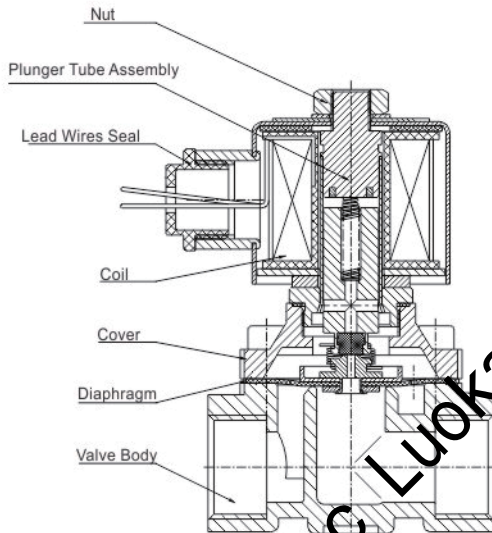

### Fluid Flow Chart

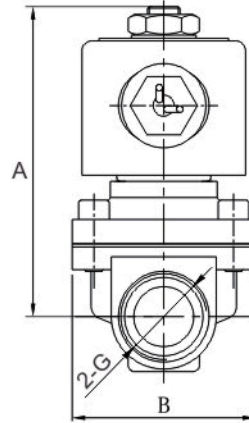
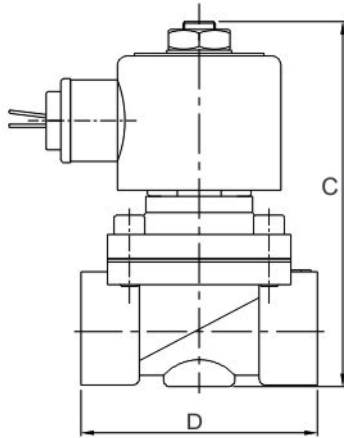
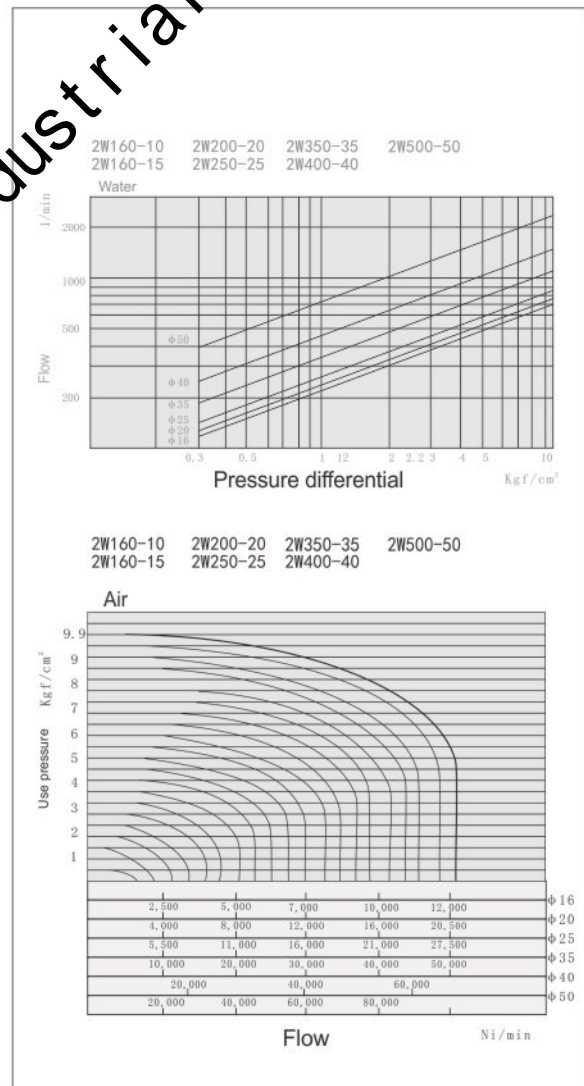

### Technical Parameter

Model code	B	C	D	G	Weight (KG)	
2W100-10	90	40.5	98	50	3/8"	0.64
2W100-15	90	40.5	98	50	1/2"	0.68
2W160-10	101.5	57	117	69	3/8"	0.9
2W160-15	101.5	57	117	69	1/2"	0.9
2W200-20	107	57	123.5	73	3/4"	1.0
2W250-25	111.5	73.5	134.5	99	1"	1.5
2W350-35	142	95	172	112	1 1/4"	2.4
2W400-40	142	95	172	123	1 1/2"	2.7
2W500-50	172	123	209	168	2"	4.5