



WZ73X Bi-directional Self Sealing Knife Gate Valve

Model: WZ73X-10
Working Pressure: DN50-DN100 16bar
 DN125-DN200 10bar
 DN250-DN400 7bar
 DN450-DN500 5Bar
 DN600-DN700 3bar
 DN800-DN900 2bar
 DN1000-DN1400 1bar

Type: Wafer
Design Standard: MSS SP-81
Flange Standard: DIN PN10, PN16, 150LB, JIS 10K, TABLE E/D
Face to Face: MSS SP-81
Testing Standard: API-598
Operation: handwheel, electric, pneumatic, hydraulic, sprocket, electro-hydraulic, gear
Main material: GGG40, CF8M, CF8
Wedge material: F55, F53, Q235, SS310, SS316L, SS316, SS304
Sealing material: NBR, FKM
Packing: high-water based, rubber packing, graphite, PTFE
Applicable medium: slurry, urban sewage treatment, sugar, powder, paper, medicine, chemicals, food and other fields

Features:

- # Bi-directional seal
- # additional seat design
- # Self sealing design, suitable for a variety of different conditions
- # 2PC strong yoke design
- # Cleaning hole design, easy for cleaning body residual medium
- # Mixed with a variety of materials packing

Product Description:

WZ73X self-sealing knife gate valve uses two rubber seats on the clip pressed the knife a sealing effect. When the knife is fully open, the two seat seals combined together tightly, the pipeline pressure will make sealing better; while the valve is closed, the gate can be arbitrarily removed convenient maintenance, no need removing the entire valve repair, not affecting the normal operation of the pipeline. The main characteristics of the valve bore full rubber seal seat, has a strong anti-wear properties and all-pass run off continuity. WZ73X bidirectional self-sealing knife gate valve is applicable to those requirements valve wear mining.

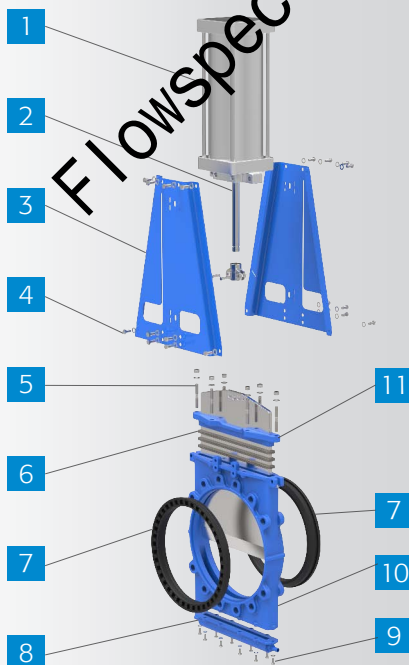

Code	Name	Material	QTY
1	Cylinder	Aluminum Alloy	1
2	Stem	2Cr13/SS304	1
3	Yoke	Q235	2
4	Bolt	Fe+Zn(Painting)/SS304	N
5	Bolt & Nut	Fe+Zn(Painting)/SS304	N
6	Packing	EPDM/NBR/FKM/PTFE	3-5
7	Seat	NBR/FKM	2
8	Bottom Cap	GGG40	1
9	Bolt	Fe+Zn(Painting)/SS304	N
10	Body	GGG40	1
11	Packing Gland	GGG40/WCB/	1

Dimension

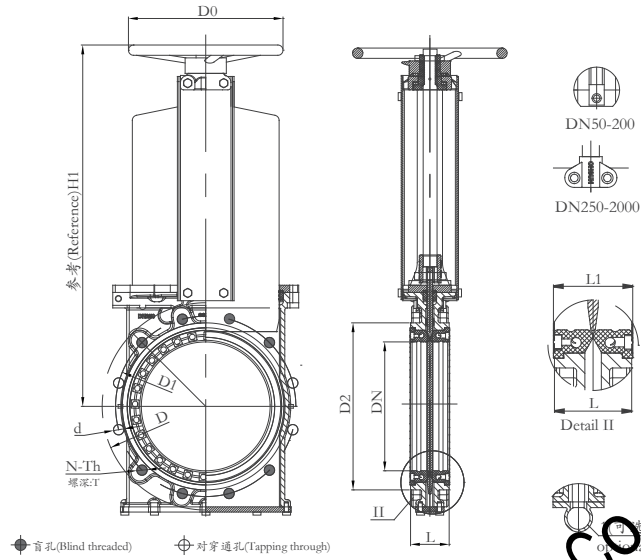

unit:mm

DIN2632 PN10									ANSI 150LB								
DN	L	D	D1	D2	D0	N-Th	d	H1	DN	L	D	D1	D2	D0	N-Th	d	H1
50	53	165	125	99	180	4-M16	Ø18	260	50	53	152	121	92	180	4-5/8"	Ø19	260
65	53	185	145	118	200	4-M16	Ø18	292	60	53	178	140	105	200	4-5/8"	Ø19	292
80	55	200	160	132	200	8-M16	Ø18	320	75	55	191	153	127	200	4-5/8"	Ø19	320
100	55	220	180	156	240	8-M16	Ø18	358	90	55	229	191	157	240	8-5/8"	Ø19	358
125	62	250	210	184	260	8-M16	Ø18	395	105	62	254	216	186	260	8-3/4"	Ø22	395
150	62	285	240	211	280	8-M16	Ø18	450	120	62	279	242	216	280	8-3/4"	Ø22	450
175	62	305	265	237	280	12-M20	Ø23	504	135	62	343	299	270	300	8-3/4"	Ø22	532
200	75	340	295	266	300	8-M20	Ø23	532	150	75	406	362	324	320	12-7/8"	Ø25	670
250	75	395	350	318	320	12-M20	Ø23	670	165	75	483	432	381	350	12-7/8"	Ø25	758
300	82	445	400	370	350	12-M20	Ø23	758	180	82	533	476	413	400	12-1"	Ø29	857
350	82	505	460	429	400	16-M20	Ø23	857	195	82	597	540	470	450	16-1"	Ø29	946
400	95	565	515	480	450	16-M24	Ø27	946	210	95	635	578	533	500	16-1 1/8"	Ø32	1023
450	95	615	565	530	500	20-M24	Ø27	1023	225	95	699	635	584	500	20-1 1/8"	Ø32	Gear
500	125	670	620	582	500	20-M24	Ø27	Gear	240	125	750	692	641	-	20-1 1/4"	Ø35	Gear
550	125	725	680	638	-	20-M27	Ø30	Gear	255	125	813	750	691	-	20-1 1/4"	Ø35	Gear
600	125	780	725	682	-	20-M27	Ø30	Gear	270	125	870	806	749	-	24-1 1/4"	Ø35	Gear
700	138	895	840	794	-	24-M27	Ø30	Gear	285	138	927	864	800	-	28-1 1/4"	Ø35	Gear
800	138	1015	950	901	-	24-M30	Ø33	Gear	300	138	985	914	857	-	28-1 1/4"	Ø35	Gear
900	138	1115	1050	1001	-	28-M30	Ø33	Gear	315	138	1060	978	914	-	28-1 1/2"	Ø41	Gear
1000	159	1230	1160	1112	-	28-M33	Ø36	Gear	330	159	1110	1029	965	-	32-1 1/2"	Ø41	Gear
1100	159	1340	1260	1220	-	28-M33	Ø36	Gear	345	159	1170	1086	1022	-	32-1 1/2"	Ø41	Gear
1200	166	1455	1380	1328	-	32-M36	Ø39	Gear	360	166	1240	1149	1073	-	32-1 1/2"	Ø41	Gear
1400	181	1675	1590	1530	-	40-M39	Ø42	Gear	375	181	1290	1200	1124	-	36-1 1/2"	Ø41	Gear

PN10 Wafer Flange Threaded and Tapping Hole

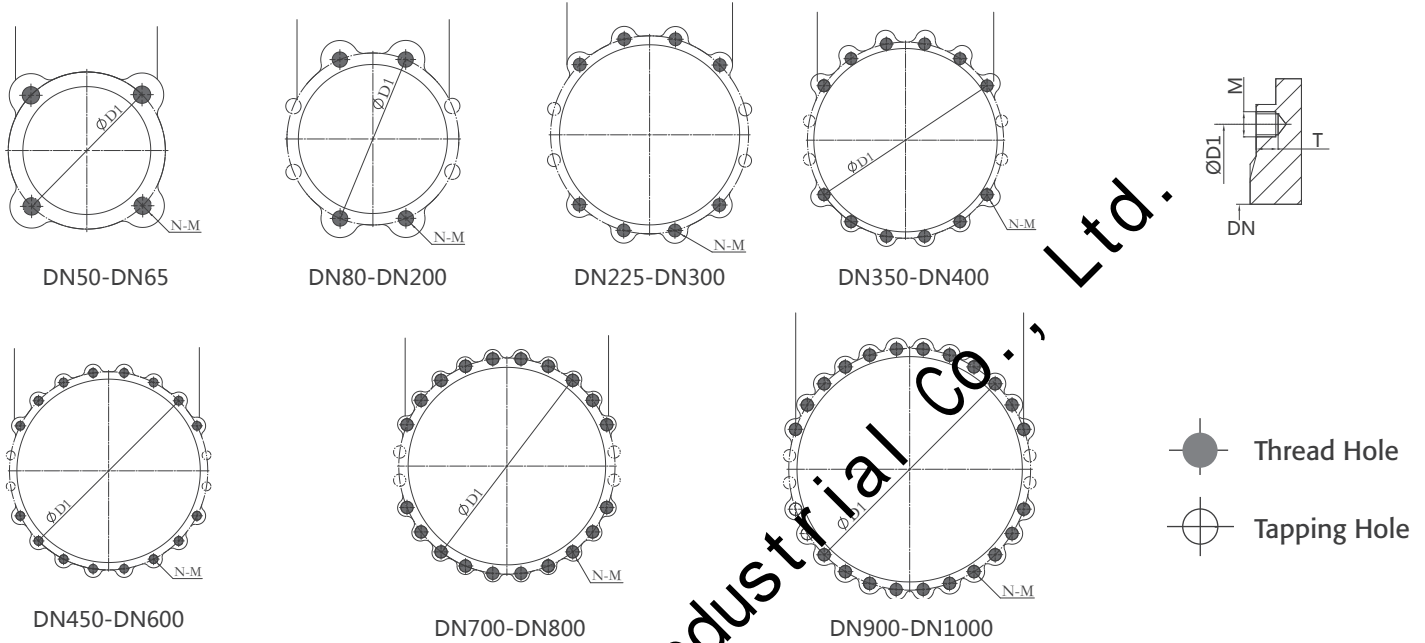

DN	D1	N	PN10		T	Thread Hole	Tapping Hole
			M				
50	125	4	M16		13	2	2
65	145	4	M16		13	2	2
80	160	8	M16		13	2	6
100	180	8	M16		13	2	6
125	210	8	M16		16	2	6
150	240	8	M16		16	2	6
200	295	8	M20		20	2	6
225	310	12	M20		20	4	8
250	350	12	M20		20	4	8
300	400	12	M20		20	4	8
350	460	16	M20		20	8	8
400	515	16	M24		24	8	8
450	565	20	M24		24	16	4
500	620	20	M24		24	16	4
550	680	20	M27		24	16	4
600	725	20	M27		27	16	4
700	840	24	M27		27	20	4
800	950	24	M30		30	20	4
900	1050	28	M30		30	24	4
1000	1160	28	M33		33	24	4

PN10 Wafer Flange Threaded and Tapping Hole

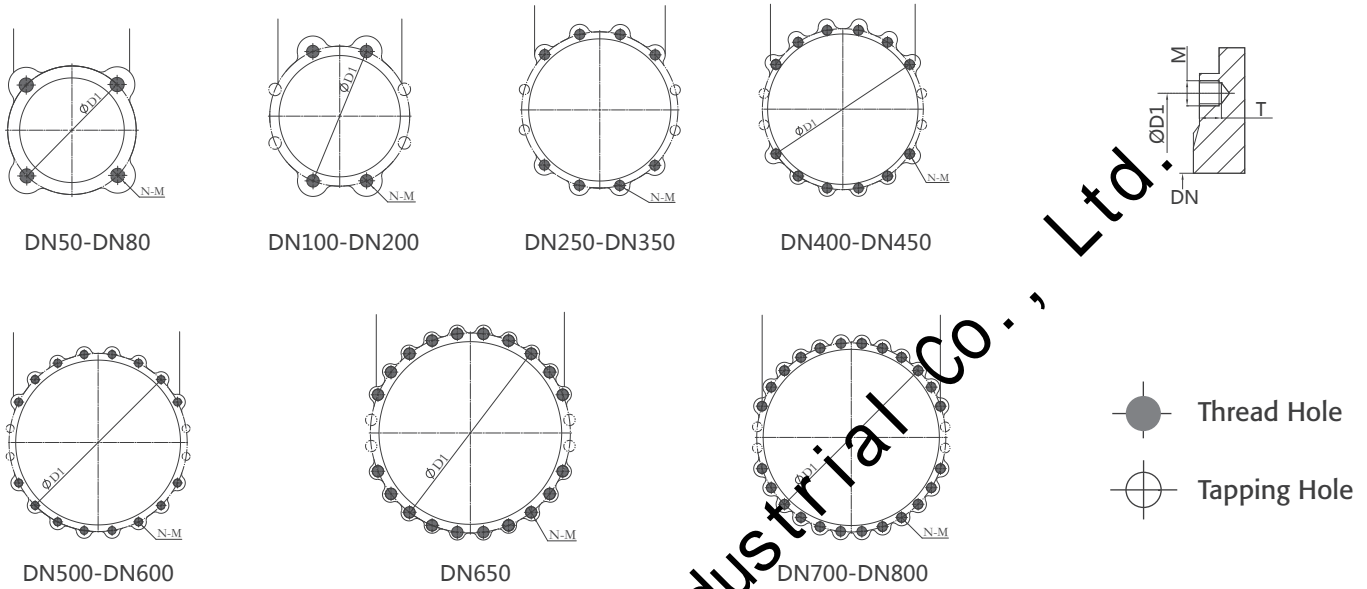

DN	D1	N	ANSI 150LB M	T	Thread Hole	Tapping Hole
2"(DN50)	121		M5/8-11	13	4	0
2-1/2"(DN65)	140	4	M5/8-11	13	4	0
3"(DN80)	153	4	M5/8-11	13	4	0
4"(DN100)	191	8	M5/8-11	13	4	4
5"(DN125)	216	8	M3/4-10	16	4	4
6"(DN150)	242	8	M3/4-10	16	4	4
8"(DN200)	289	8	M3/4-10	20	4	4
10"(DN250)	362	12	M7/8-9	20	8	4
12"(DN300)	432	12	M7/8-9	20	8	4
14"(DN350)	476	12	M1-8	20	8	4
16"(DN400)	540	16	M1-8	24	12	4
18"(DN450)	578	16	M1 1/8-7	24	12	4
20"(DN500)	635	20	M1 1/8-7	24	16	4
22"(DN550)	692	20	M1 1/4-7	24	16	4
24"(DN600)	750	20	M1 1/4-7	27	16	4
26"(DN650)	806	24	M1 1/4-7	27	20	4
28"(DN700)	864	28	M1 1/4-7	27	24	4
30"(DN750)	914	28	M1 1/4-7	27	24	4
32"(DN800)	978	28	M1 1/2-6	30	24	4