

INVERTED BUCKET TYPE STEAM TRAP

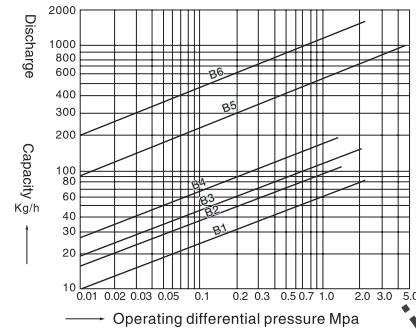
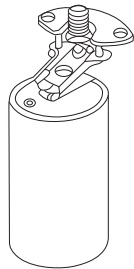
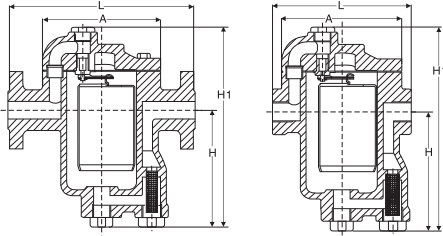

PRODUCT INTRODUCTION

Applied industries of petroleum, textile, foods, paper making, chemical and steam pipeline.

ADVANTAGE

1. Simple structure with no gemel structure and fixed abrasive. Excellent ability of energy saving.
2. Valve base is made of chrome alloy and has a long service life.
3. The waste will be constantly washed away.
4. Maintenance is facilitative.

MIAN PARTS MATERIALS

Model	B1	B2	B3
Body/Cap	Cast iron, Cast steel, Stainless steel		
Seat/Core	Hardened Chrome steel		
Other internal parts	Stainless steel		

MAIN CONNECTION SIZE

Model	Size	L(mm)	H	H1	Weight (kg)	max. pressure	
B1	1/2", 3/4", 1"	128	100	175	96	21	18bar
B2	3/4", 1"	165	133	228	144	3.5	18bar
B3	1"	198	173	296	178	7.2	18bar
B4	1-1/2"	232	185	347	203	13.5	18bar

Model	Size	L(mm)	H	H1	A	Weight (kg)	max. pressure
B1F	1/2", 3/4", 1"	170	100	175	96	4.8, 5, 6	18bar
B2F	3/4", 1"	210	133	228	144	9, 10	18bar
B3F	1"	240	173	296	178	15	18bar
B4F	1-1/4", 1-1/2"	280	185	347	203	24, 25	18bar
B5F	1-1/2", 2"	300	223	388	230	31, 33, 5	18bar
B6F	2"	350	260	446	273	45.5	18bar

FREE FLOAT BALL TYPE STEAM TRAP

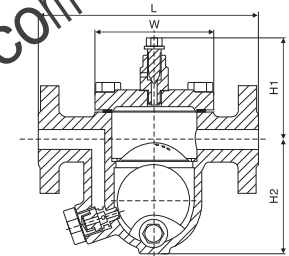
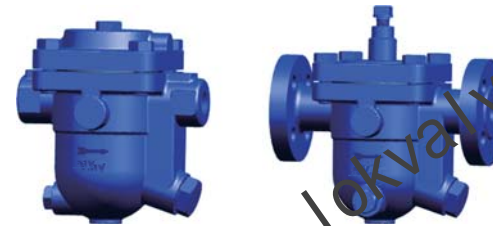

PRODUCT INTRODUCTION

Free float trap is one of the most advanced traps since its of timely discharge of the condensed water in the pipelines and heating equipment. This trap has an extensive application in petroleum, chemical industry, light textile, printing, pharmacy, paper making, foods and medicines.

ADVANTAGE

1. Stable discharge of water with large amount, small rate of steam leakage, high rate of black pressure.
2. The main part hollow free-ball of steel is finely ground in the trap.
3. The structure of stainless steel provide the ability of anti-corruption and longer service life.

MIAN PARTS MATERIALS

Body, bonnet	Cast iron, Cast steel, Stainless steel
Float Ball	Stainless steel
Seat	Chromium Stainless Steel
Internal Filters	Stainless Steel
Gasket	The Stainless Steel Metal Twine the pad

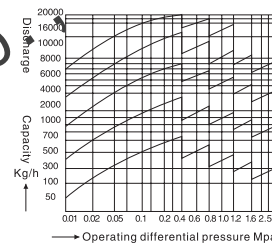

MIAN CONNECTION SIZE

Model	Nominal diameter DN	Connection	Pressure range Mpa	Max allowable Temp(°C)	External dimensions(mm)				Re. weight (kg)				
					L	L1	H2	W					
CS61H-16C-B CS11H-16C-D	15-25	Thread Socket Weld	0.01-1.6	300 300	150	170	85	100	128	100	120	6	8.5
	32-50				230	100	165	185	14				
CS41H-16C-B CS41H-25C-B CS41H-40C-B	15-20 25	Flange	0.01-4.0	300 350 425	195	210	100	120	135	11			
	15-20 25				250	100	130	135	12.5				
	20-32				270	10	165	175	16.5				
CS41H-16C-D CS11H-25C-D CS41H-40C-D	40 50	Flange	0.01-4.0 0.01-4.0	300 350 425	270	290	105	165	175	18.5			
	20-50				350	125	190	200	27				
	50-65 80				410	430	130	250	270	52			
S41H-16C-F CS41H-25-F CS41H-40-F	50-65 80-100	Flange	0.01-4.0	300 350 425	430	130	260	270	67				
	80-100				430	130	260	270	39				
	80-100				550	150	310	285	85				
CS41H-16C-G CS41-25-G CS41H-40-G	80-100	Flange	0.01-4.0	300 350 425	570	190	340	315	108				
	80-150				570	190	340	315	116				
	150-200				575	210	360	330	143				